



country properties  
village properties  
town homes  
barn conversions  
building plots

Bowen Road  
Darlington, DL3 0TH

**Price £159,000**

**NICK & GORDON**  
**CARVER**  
RESIDENTIAL

Offered for sale with NO ONWARD CHAIN, this impressive THREE bedroomed semi-detached property is located within the ever popular area of COCKERTON VILLAGE. Internal viewing will reveal a light and welcoming hallway, a well appointed living room with feature Inglenook style fireplace together with stripped and polished floorboards, a formal separate dining room perfect for entertaining, the extended kitchen is fitted with a range of units, integrated appliances and doors opening to SOUTH FACING rear garden.

To the first floor is a landing area, master bedroom with fitted wardrobes, and two further good sized bedrooms, the bathroom/WC benefits from having a white suite and overhead shower. Externally to the front is an extensive BLOCK PAVED driveway allowing off road parking, and side gated access opening to enclosed south facing rear garden with attractive patio together with lawn, ideal to enjoy the summer sun.

EARLY VIEWING WILL IMPRESS AS PROPERTIES WITHIN THIS SOUGHT AFTER AREA ARE IN HIGH DEMAND.





- NO ONWARD CHAIN
- EXTENDED TO THE REAR
- EXTENDED KITCHEN WITH APPLIANCES
- FIRST FLOOR BATHROOM/WC
- SOUTH FACING REAR GARDEN
- STYLISH READY TO MOVE INTO
- TWO RECEPTION ROOMS
- THREE SIZEABLE BEDROOMS
- EXTENSIVE BLOCK PAVED DRIVE
- POPULAR LOCATION

#### **GENERAL INFORMATION**

Tenure: Freehold

Services: Gas central heating, mains electric, water and drainage.

Double glazing

Local Authority: Darlington Borough Council (Tax Banding A)

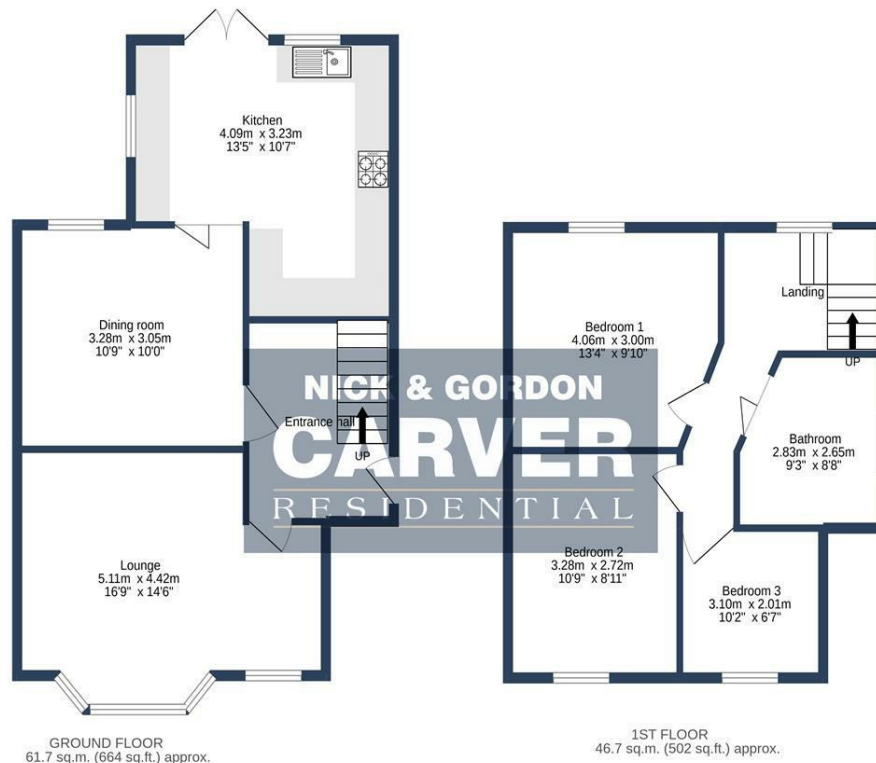

**NICK & GORDON  
CARVER  
RESIDENTIAL**

BOWEN ROAD, DARLINGTON. DL3 0TH.

TOTAL FLOOR AREA: 108.3 sq.m. (1166 sq.ft.) approx.

Whilst every attempt has been made to ensure the accuracy of the floorplan contained here, measurements of doors, windows, stairs and any other items are approximate and no responsibility is taken for any error, omission or mis-statement. This plan is for illustrative purposes only and should be used as such by any prospective purchaser. The services, systems and appliances shown have not been tested and no guarantee as to their operability or efficiency can be given.  
Made with Metropix ©2022

Energy Efficiency Rating		
	Current	Potential
Very energy efficient - lower running costs		
(92 plus) <b>A</b>		<b>82</b>
(81-91) <b>B</b>		
(69-80) <b>C</b>		
(55-68) <b>D</b>		
(39-54) <b>E</b>	<b>56</b>	
(21-38) <b>F</b>		
(1-20) <b>G</b>		
Not energy efficient - higher running costs		
<b>England &amp; Wales</b>	EU Directive 2002/91/EC	

**We can search 1,000s of mortgages for you**

It could take just 15 minutes with one of our specialist advisers:  
Call: 01325 380088. Visit: Any of our Offices. Online: [www.mortgageadvicebureau.com/carver](http://www.mortgageadvicebureau.com/carver)



Your home may be repossessed if you do not keep up repayments on your mortgage. There will be a fee for mortgage advice. The actual amount you pay will depend upon your circumstances. The fee is up to 1% but a typical fee is 0.3% of the amount borrowed

MAB 6202



These particulars do not constitute any part of an offer or contract. None of the statements contained in these particulars are to be relied on as statements or representations of fact and any intending purchaser must satisfy himself by inspection or otherwise to the correctness of each of the statements contained in these particulars. The vendor does not make or give, and neither Nick & Gordon Carver Residential or Commercial, Nick & Gordon Carver, nor any person in their employment has any authority to make or give any representation or warranty whatever in relation to this property

80 High Street  
Yarm, TS15 9AH  
Tel: 01642 420090  
[yarm@carvergroup.co.uk](mailto:yarm@carvergroup.co.uk)

14 Duke Street, Darlington  
County Durham, DL3 7AA  
Tel: 01325 357807  
[sales@carvergroup.co.uk](mailto:sales@carvergroup.co.uk)

26 Market Place, Richmond  
North Yorkshire, DL10 4QG  
Tel: 01748 825317  
[richmond@carvergroup.co.uk](mailto:richmond@carvergroup.co.uk)

43 Dalton Way, Newton Aycliffe  
County Durham, DL5 4DJ  
Tel: 01325 320676  
[aycliffe@carvergroup.co.uk](mailto:aycliffe@carvergroup.co.uk)

219 High Street, Northallerton  
North Yorkshire, DL7 8LW  
Tel: 01609 777710  
[northallerton@carvergroup.co.uk](mailto:northallerton@carvergroup.co.uk)